

alutec



NUOVE Chiusure
per scorrevoli

N E W Sliding
opening locks

Ghibli



280.195.XX

Chiusura automatica convertibile in manuale

Chiusura automatica convertibile in manuale, fissaggio frontale con viti e contropiastra, corpo in alluminio, movimentazione in zama, viti incluse

Finishes	01	02	03	04	05	08	24	28	98
Finishes	60	61	62	65	67	69	71	72	75

Automatic locking convertible in non automatic

Automatic locking convertible in non automatic, front fastening by means of screws and counterplate, aluminium body, zamak device, screws included

Pezzi per conf. nr.	20
Box quantity pcs	

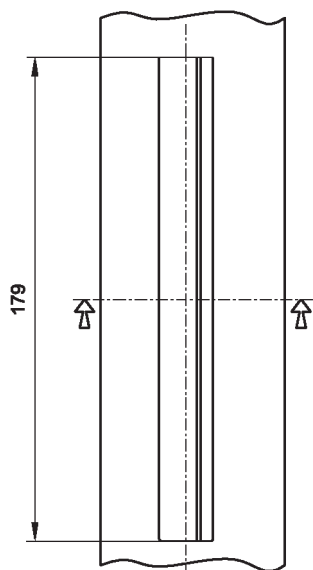
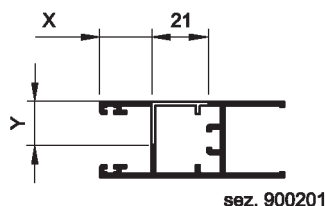

280.196.XX

Chiusura automatica convertibile in manuale

Chiusura automatica convertibile in manuale, fissaggio con contropiastra a scomparsa, corpo in alluminio, movimentazione in zama

Finishes	01	02	03	04	05	08	24	28	98
Finishes	60	61	62	65	67	69	71	72	75

Automatic locking convertible in non automatic

Automatic locking convertible in non automatic fastening by means of hidden counterplate, aluminium body, zamak device

Pezzi per conf. nr.	20
Box quantity pcs	

SERIE	X	Y
R50s	19.0	16.0
R50s revamping	20.6	20.0
Win65	14.0	3.5
Win65TT	14.0	3.5
Win90	19.0	7.0
Win90TT	19.0	7.0
R950	26.0	1.9
R800	18.0	1.5
R800 new	18.0	1.5

NUOVE Chiusure per scorrevoli
NEW Sliding opening locks



Applicazione
Lavorazioni consigliate
Geometrie

Application
Recommended processing
Geometries

Cod.	R50s	R50s revamping	Win65	Win65TT	Win90	Win90TT	R950	R800	R800 new
280.195.XX	●	●	●	●	●	●	●	●	●
280.196.XX	●	●	●	●	●	●	●	●	●



280.193.XX

Vaschetta
ad incasso

Vaschetta ad incasso,
corpo in zama

in abbinamento a cod. 280.195.XX

Finiture Finishings	01	02	03	04	05	08	24	28	98
	60	61	62	65	67	69	71	72	75

**Built-in
side locking**

Built-in side locking,
zamak body

to be used with code 280.195.XX

Pezzi per conf. nr. Box quantity pcs	10
---	----

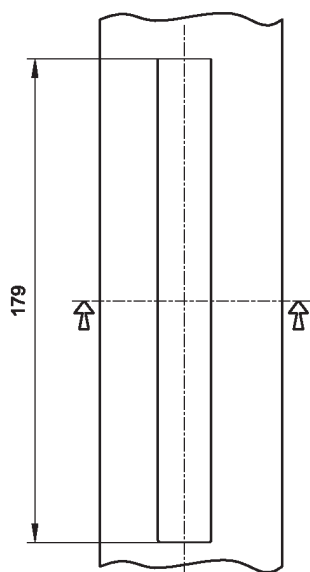
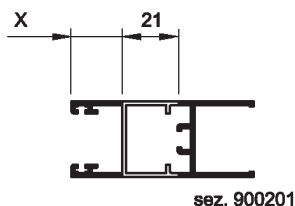

280.194.XX

Chiusura doppia
con chiave

Chiusura doppia con chiave,
corpo in alluminio e zama,
movimentazione in zama

Finiture Finishings	01	02	03	04	05	08	24	28	98
	60	61	62	65	67	69	71	72	75

**Double locking
with key**

Double locking with key,
zamak aluminium body,
zamak device

Pezzi per conf. nr. Box quantity pcs	10
---	----

SERIE	X
R50s	19.0
R50s revamping	20.6
Win65	14.0
Win65TT	14.0
Win90	19.0
Win90TT	19.0
R950	26.0
R800	18.0
R800 new	18.0

NUOVE Chiusure
per scorrevoli
NEW Sliding
opening locks

Ghibli

Cod.	R50s	R50s revamping	Win65	Win65TT	Win90	Win90TT	R950	R800	R800 new
280.193.XX	●	●	●	●	●	●	●	●	●
280.194.XX	●	●	●	●	●	●	●	●	●



280.191.XX

Maniglia di traino

Maniglia di traino in zama, viti inox di fissaggio

Finiture Finishings	01	02	03	04	05	08	24	28	98
	60	61	62	65	67	69	71	72	75

Pull handle

Pull handle zamak body, fastening screws included

Pezzi per conf. nr. Box quantity pcs	10
---	----

280.192.XX

Maniglia di traino per chiusura laterale

Maniglia di traino per chiusura laterale in zama, in abbinamento a cod. 280.195.XX e cod. 280.194.XX

Finiture Finishings	01	02	03	04	05	08	24	28	98
	60	61	62	65	67	69	71	72	75

Pull handle for side locking

Pull handle for side locking zamak body, to be used with code 280.195.XX, 280.194.XX

Pezzi per conf. nr. Box quantity pcs	10
---	----

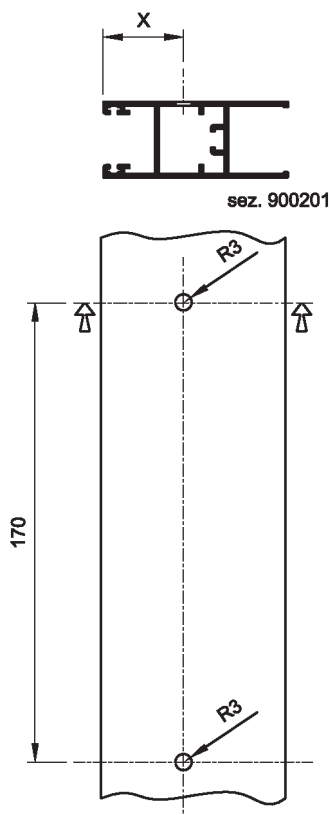

SERIE	X
R50s	29.5
R50s revamping	25.5
Win65	29.0
Win65TT	29.0
Win90	29.5
Win90TT	29.5
R950	36.5
R800	28.5
R800 new	28.5

L'accessorio viene vincolato all'articolo cod. 280.194.XX e/o 280.195.XX

The accessory is bound to article code 280.194.XX and/or 280.195.XX

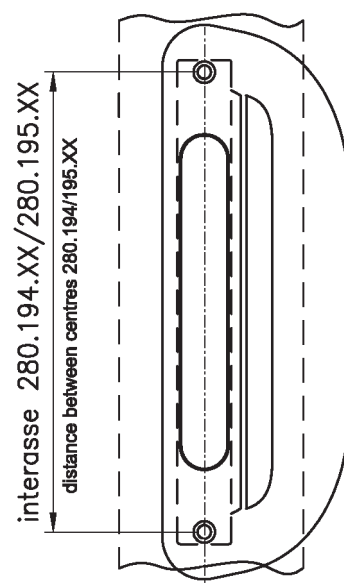

Cod.	R50s	R50s revamping	Win65	Win65TT	Win90	Win90TT	R950	R800	R800 new
280.191.XX	●	●	●	●	●	●	●	●	●
280.192.XX	●	●	●	●	●	●	●	●	●

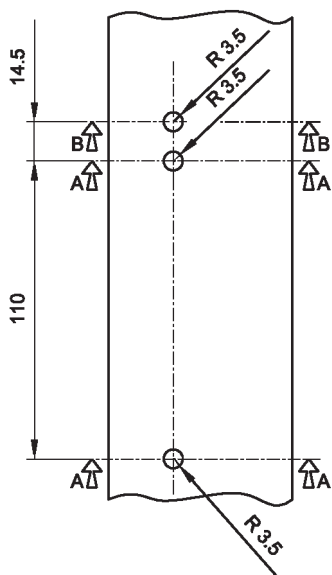
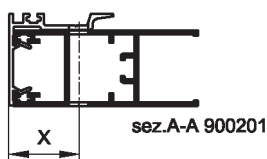
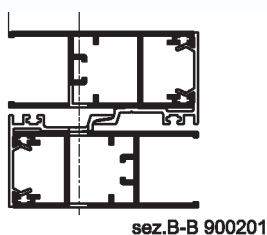

280.184.XX
280.185.XX
280.186.XX

Finiture	01	02	03	04	05	08	24	28	98
Finishings	60	61	62	65	67	69	71	72	75

Chiusura a pulsante
 Chiusura a pulsante,
 corpo in pressofuso di zama,
 perno in acciaio inox

Push-button locking
 Push-button locking,
 die-cast zamak body,
 stainless steel pivot

Pezzi per conf. nr.	20
Box quantity pcs	

SERIE	X	Y
R50s	24.0	25.0
R50s revamping	20.0	20.0
Win65	45.5	55.5
Win65TT	45.5	55.5
Win90	46.5	56.5
Win90TT	46.5	56.5
R950	30.0	30.0
R800	28.0	28.0
R800 new	25.0	25.0

Applicazione
 Lavorazioni consigliate
 Geometrie

Application
 Recommended processing
 Geometries

NUOVE Chiusure per scorrevoli
NEW Sliding opening locks



Cod.	R50s	R50s revamping	Win65	Win65TT	Win90	Win90TT	R950	R800	R800 new
280.184.XX								●	●
280.185.XX	●	●	●	●					
280.186.XX					●	●	●		

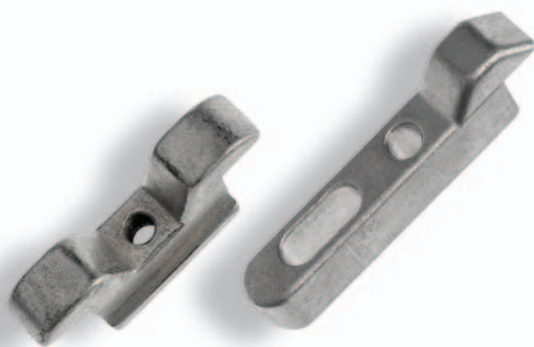

280.188.01

Riscontro di chiusura

Riscontro di chiusura registrabile in zama

Finiture	01	02	03	04	05	08	24	28	98
Finishings	60	61	62	65	67	69	71	72	75

Locking striker

Zamak adjustable locking striker

Pezzi per conf. nr. **40**
Box quantity pcs

280.187.01 280.189.01

Riscontro di chiusura

Riscontro di chiusura registrabile in zama

Finiture	01	02	03	04	05	08	24	28	98
Finishings	60	61	62	65	67	69	71	72	75

Locking striker

Zamak adjustable locking striker

Pezzi per conf. nr. **40**
Box quantity pcs

Applicazione
Lavorazioni consigliate
Geometrie

Application
Recommended processing
Geometries

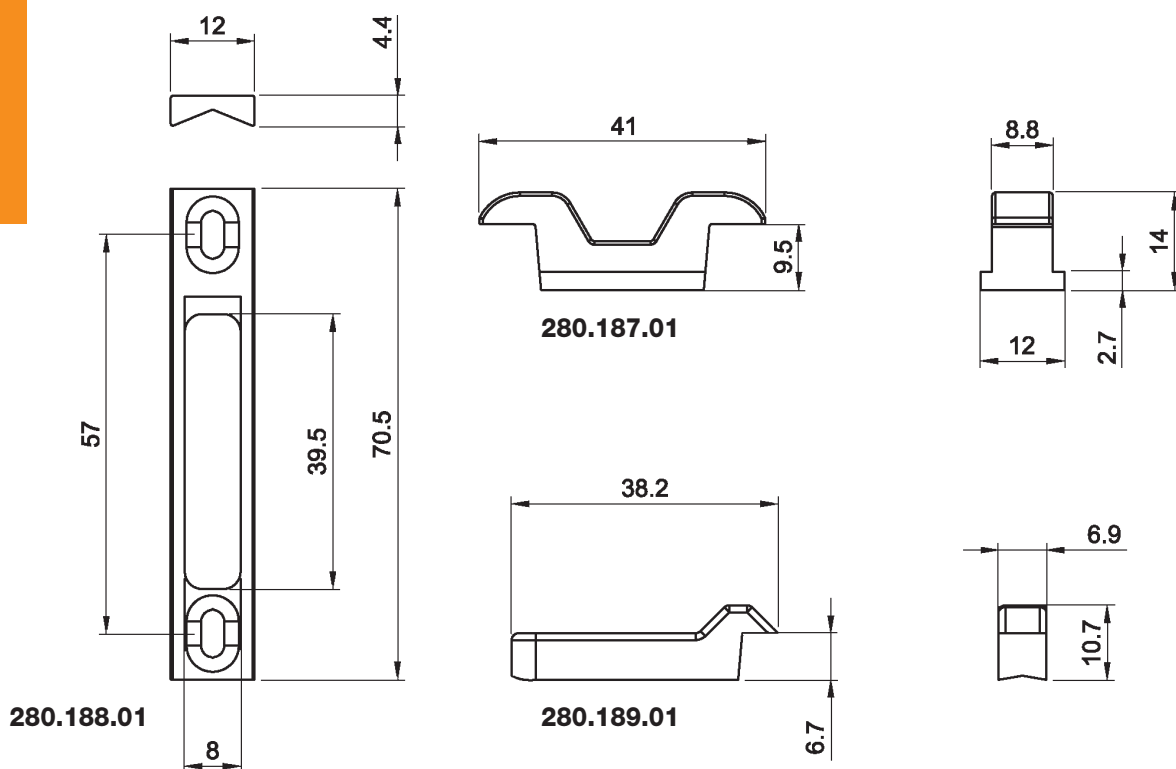

Cod.	R50s	R50s revamping	Win65	Win65TT	Win90	Win90TT	R950	R800	R800 new
280.188.01	●	●	●	●	●	●			
280.187.01							●		
280.189.01								●	●

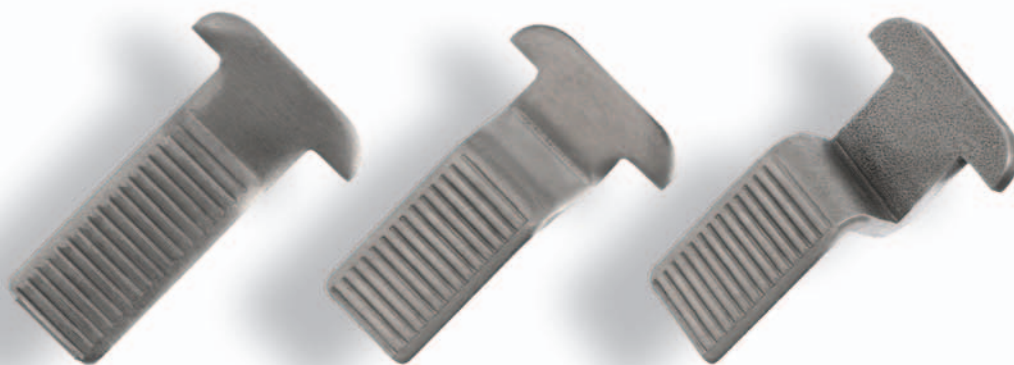

280.197.00
280.198.00
280.199.00

Nasello di chiusura
 Nasello di chiusura in acciaio inox

Finiture Finishings	01	02	03	04	05	08	24	28	98
	60	61	62	65	67	69	71	72	75

Locking catch
 Stainless steel locking catch

Pezzi per conf. nr.
 Box quantity pcs **40**

Applicazione
 Lavorazioni consigliate
 Geometrie

Application
 Recommended processing
 Geometries

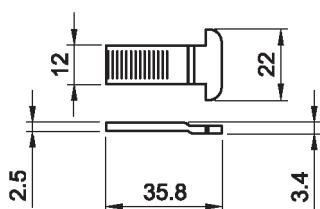

280.197.00

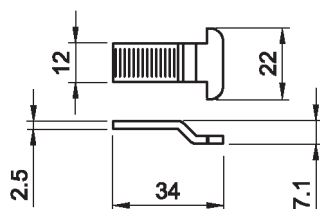

280.198.00

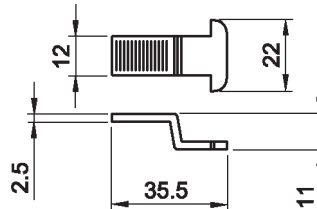

280.199.00

NUOVE Chiusure
 per scorrevoli
NEW Sliding
 opening locks

Ghibli

Cod.	R50s	R50s revamping	Win65	Win65TT	Win90	Win90TT	R950	R800	R800 new
280.197.00	●	●						●	●
280.198.00			●	●					
280.199.00					●	●	●		

Cod.	R50s	R50s revamping	Win65	Win65TT	Win90	Win90TT	R950	R800	R800 new
280.184.XX								●	●
280.185.XX	●	●	●	●					
280.186.XX					●	●	●		
280.187.01							■		
280.188.01	■	■	■	■	■	■			
280.189.01								■	■
280.191.XX	●	●	●	●	●	●	●	●	●
280.192.XX	●	●	●	●	●	●	●	●	●
280.193.XX	●	●	●	●	●	●	●	●	●
280.194.XX	●	●	●	●	●	●	●	●	●
280.195.XX	●	●	●	●	●	●	●	●	●
280.196.XX	●	●	●	●	●	●	●	●	●
280.197.00	■	■						■	■
280.198.00			■	■					
280.199.00					■	■	■		

● Gli articoli così contrassegnati sono utilizzabili sulla Serie di applicazione indicata.

Marked accessories can be applied on the indicated series.

■ Gli articoli così contrassegnati vanno acquistati assieme per Serie di applicazione.

Marked accessories must be bought together according to the compatible series.



Progettazione e produzione
accessori per serramenti in alluminio,
porte, finestre e facciate continue

*Design and Production
accessories for aluminium doors,
windows and curtain walls*

ALUTEC srl
Via Travnik, 16
34147 San Dorligo della Valle (Trieste) Italy
Tel. +39 040 8999 111 - Fax +39 040 830 204

E-mail: info@alutec.it
www.alutec.it